



OUTSIDE IN

You'll struggle to find a more stylish or cost efficient way of enhancing your home than a garden room from Low Carbon Studio and Alba Green Oak Frames

WORDS: LYNN STEWART

Over the last few years there has been a trend in house design to extend properties into the garden and linking internal spaces to the outside with a garden room. This trend has seen Low Carbon Studio and Alba Green Oak Frames undertake around a dozen garden room projects over the last seven or eight years.

There are a number of benefits in having a garden room, not least being the fact that they

are a really affordable way of adding space to your current property, without the hassle, stress and expense of selling your house and buying a new one – particularly with the recent increase in property prices that have been witnessed in areas such as East Lothian.

There is a range of different ways in which a garden room can be added to your house. The most common form of garden room extension

tends to link a new garden or family room with an existing or new kitchen/dining room. This creates a large, bright space that will form the hub of any family home – an ideal space for relaxing with family and friends, enjoying family dinners, or providing a space for the kids to do their homework, or play music and games. More often than not, home owners imagine that their garden room will be used only occasionally, when in reality they become the most used spaces in the house.

Garden rooms function particularly well as internal spaces linked to the outside with the installation of a folding glazed screen as part of large, glazed areas. This allows lots of natural light to flood in and, where the plot will allow, if the space is located on the south it will maximise solar gain. If a raised timber deck, or a patio space is laid directly outside the garden room, then during warmer weather (which perhaps doesn't happen as often as we would like) the garden room can be opened up.

Of course, even when the weather isn't so good, the addition of a log burning stove can

provide a garden room with that warm, cosy and intimate feel. A fire is something that most people associate with comfort and relaxation – evoking fond childhood memories of sitting in front of a cosy fire, watching television or playing games with your family.

When Low Carbon Studio and Alba Green Oak Frames begin a garden room project, they are always careful to ensure that in the initial designs the appearance of the garden room fits into the existing house and garden. By linking new internal and external materials, and taking things like roof pitch and scale into account, they can offer peace of mind that the completed garden room will enhance the existing building.

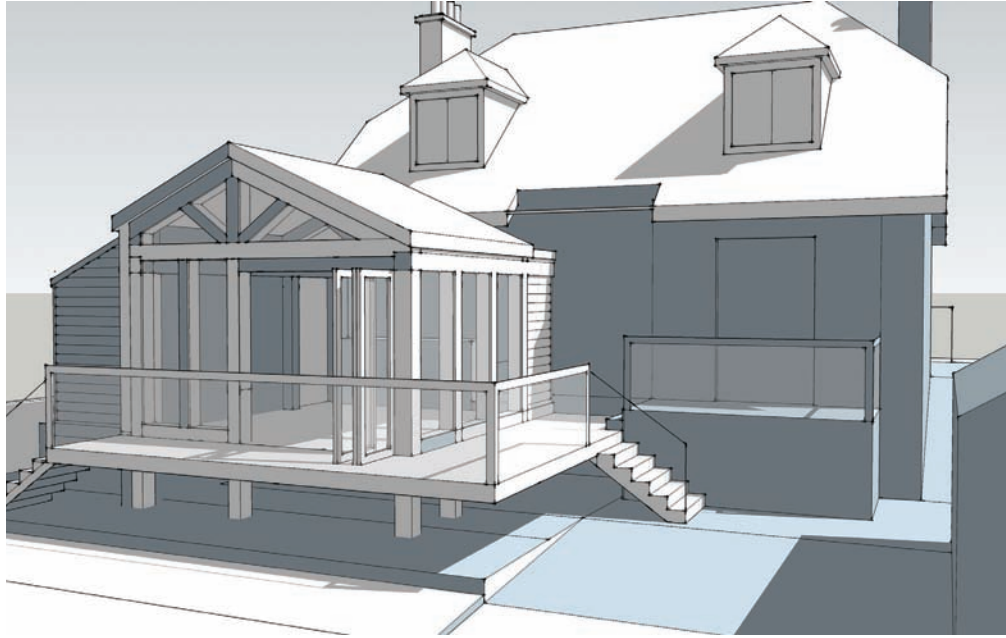

Whether it's oak or Douglas fir, timber frames add real character to a garden room. And, because it's a natural material, the wooden frame provides a strong link from the interior of the property to the garden and the natural external environment. Homeowners who decide to build their garden rooms with a timber frame are never disappointed – the space that is created, and the feeling that it gives, is always worth the investment.

When it comes to constructing the timber frames of your new garden room, Low Carbon Studio and Alba Green Oak Frames use pegged joints – a traditional construction technique that has been around

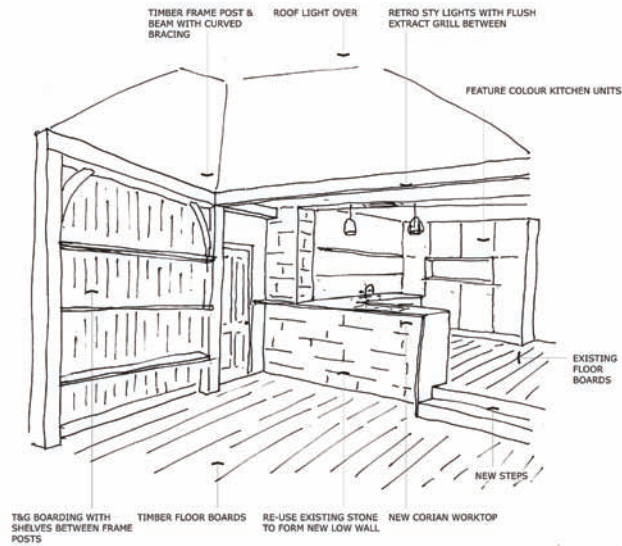

for centuries. When this traditional craftsmanship is combined with contemporary detailing and modern internal fixtures such as a kitchen, furniture and lighting, it provides a stunning contrast and creates a modern, up-to-date finish.

Low Carbon Studio and Alba Green Oak Frames have a number of garden room projects currently in the process of design, awaiting planning/building warrant approval or in pre-production, some of which they hope to show you in more detail over the next 12-18 months. Watch this space. TC